

CITY OF GIG HARBOR

ORDINANCE NO. 589

AN ORDINANCE OF THE CITY OF GIG HARBOR, WASHINGTON, VACATING THE PORTION OF GOODMAN AVENUE, LYING SOUTH OF HALL STREET AND NORTH OF SELLERS STREET.

WHEREAS, the referenced portion of right-of-way is undeveloped; and

WHEREAS, the referenced portion of right-of-way is not necessary to the street and circulation plans of the city; and

WHEREAS, the City Council passed Resolution No. 290 initiating the procedure for the vacation of the referenced street and setting a hearing date; and

WHEREAS, after the required public notice had been given, the City Council conducted a public hearing on the matter on August 27, 1990, and at the conclusion of such hearing determined that the aforementioned right-of-way should be vacated.

NOW, THEREFORE, the City Council of the City of Gig Harbor, Washington, ORDAINS as follows:

Section 1. The portion of the street currently known as Goodman Avenue, originally platted at Chahal's Street in Gig Harbor, which lies south of the street currently known as Hall Avenue and originally platted as Ash Street and north of Sellers Street, originally platted as Oak Street, as shown on the plat files on August 20, 1890, denominated as the Town of Ardena, Pierce County, Washington, except the westerly twenty-two feet (22') of Goodman (Chehalis) extending north of Sellers (Oak) Street one hundred and forty feet (140') to Parcel #02-21-5-2-087 which shall be preserved as public access to Parcels #02-21-5-2-087 and 02-21-5-2-075, attached hereto as Exhibit 1 and incorporated by this reference as if set forth in full, is hereby vacated.

Ordinance Vacating Goodman Avenue  
Page 2

The City of Gig Harbor shall retain a utility easement of 15 feet in the above-referenced property for construction and maintenance purposes of city utilities, centered on center line.

Section 2. The City Clerk is hereby directed to record a certified copy of this ordinance with the office of the Pierce County Auditor and the Clerk of the County Council.

Section 3. This ordinance shall take effect five days after passage and publication as required by law and payment of one-half of the appraised value. Upon such payment, the City Clerk shall record a notice that such amount has been paid with the Office of the Pierce County Auditor and the Clerk of the County Council.

PASSED by the City Council of the City of Gig Harbor, Washington, and approved by its Mayor at a regular meeting of the council held on this 10th day of September, 1990.

  
Gretchen A. Wilbert, Mayor

ATTEST:

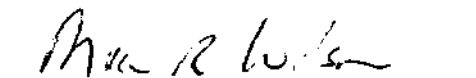
  
Michael R. Wilson  
City Administrator/Clerk

Filed with city clerk: 8/10/90  
Passed by city council: 9/10/90  
Date published: 9/26/90  
Date effective: 10/1/90

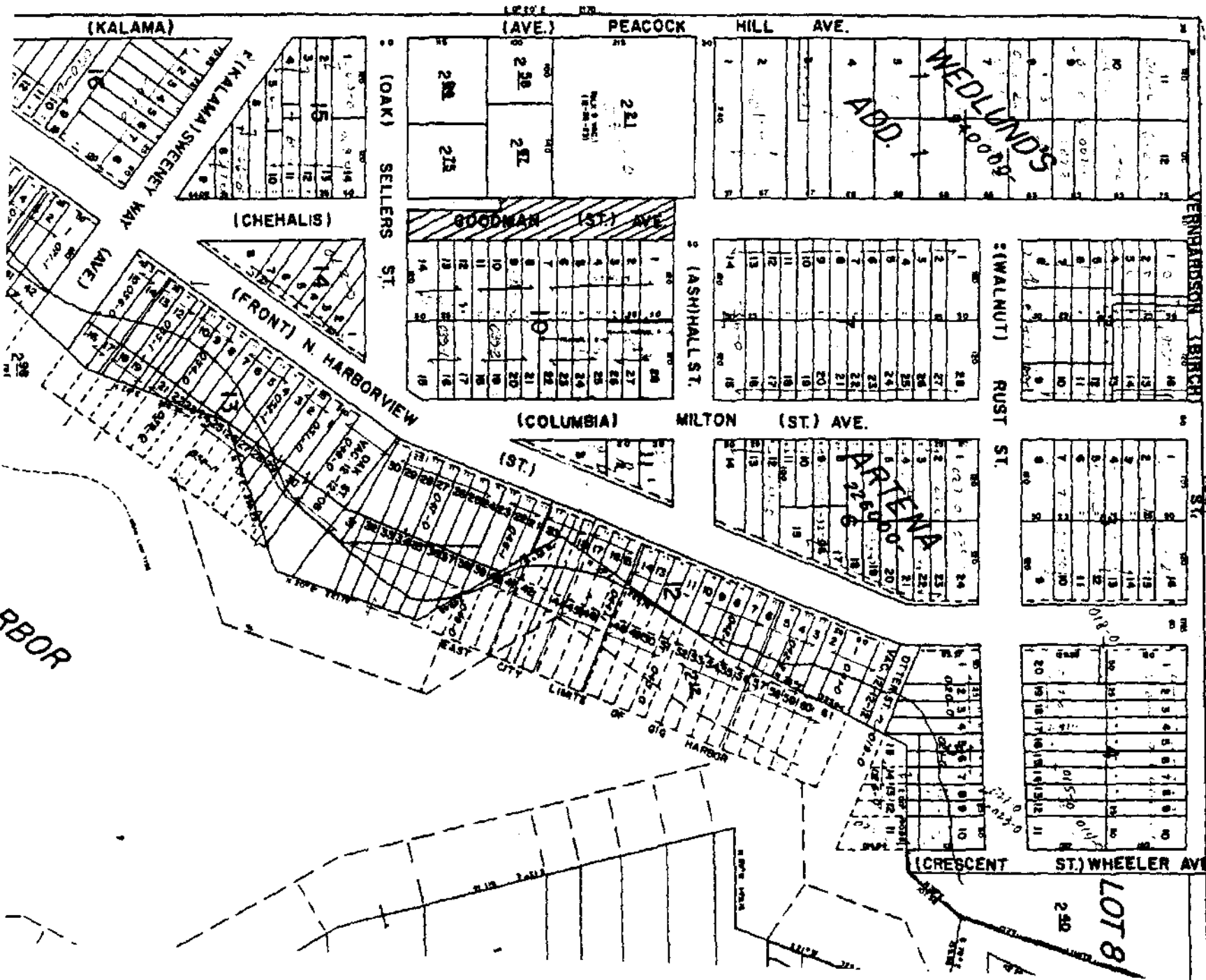

EXHIBIT 1

SEE MAP 5 OF PROJECT 81  
SEE MAP 6 OF PROJECT 81  
SEE MAP 7 OF PROJECT 81  
SEE MAP 8 OF PROJECT 81  
SEE MAP 9 OF PROJECT 81  
SEE MAP 10 OF PROJECT 81  
SEE MAP 11 OF PROJECT 81  
SEE MAP 12 OF PROJECT 81  
SEE MAP 13 OF PROJECT 81  
SEE MAP 14 OF PROJECT 81  
SEE MAP 15 OF PROJECT 81  
SEE MAP 16 OF PROJECT 81  
SEE MAP 17 OF PROJECT 81  
SEE MAP 18 OF PROJECT 81  
SEE MAP 19 OF PROJECT 81  
SEE MAP 20 OF PROJECT 81  
SEE MAP 21 OF PROJECT 81  
SEE MAP 22 OF PROJECT 81  
SEE MAP 23 OF PROJECT 81  
SEE MAP 24 OF PROJECT 81  
SEE MAP 25 OF PROJECT 81  
SEE MAP 26 OF PROJECT 81  
SEE MAP 27 OF PROJECT 81  
SEE MAP 28 OF PROJECT 81  
SEE MAP 29 OF PROJECT 81  
SEE MAP 30 OF PROJECT 81  
SEE MAP 31 OF PROJECT 81  
SEE MAP 32 OF PROJECT 81  
SEE MAP 33 OF PROJECT 81  
SEE MAP 34 OF PROJECT 81  
SEE MAP 35 OF PROJECT 81  
SEE MAP 36 OF PROJECT 81  
SEE MAP 37 OF PROJECT 81  
SEE MAP 38 OF PROJECT 81  
SEE MAP 39 OF PROJECT 81  
SEE MAP 40 OF PROJECT 81  
SEE MAP 41 OF PROJECT 81  
SEE MAP 42 OF PROJECT 81  
SEE MAP 43 OF PROJECT 81  
SEE MAP 44 OF PROJECT 81  
SEE MAP 45 OF PROJECT 81  
SEE MAP 46 OF PROJECT 81  
SEE MAP 47 OF PROJECT 81  
SEE MAP 48 OF PROJECT 81  
SEE MAP 49 OF PROJECT 81  
SEE MAP 50 OF PROJECT 81  
SEE MAP 51 OF PROJECT 81  
SEE MAP 52 OF PROJECT 81  
SEE MAP 53 OF PROJECT 81  
SEE MAP 54 OF PROJECT 81  
SEE MAP 55 OF PROJECT 81  
SEE MAP 56 OF PROJECT 81  
SEE MAP 57 OF PROJECT 81  
SEE MAP 58 OF PROJECT 81  
SEE MAP 59 OF PROJECT 81  
SEE MAP 60 OF PROJECT 81  
SEE MAP 61 OF PROJECT 81  
SEE MAP 62 OF PROJECT 81  
SEE MAP 63 OF PROJECT 81  
SEE MAP 64 OF PROJECT 81  
SEE MAP 65 OF PROJECT 81  
SEE MAP 66 OF PROJECT 81  
SEE MAP 67 OF PROJECT 81  
SEE MAP 68 OF PROJECT 81  
SEE MAP 69 OF PROJECT 81  
SEE MAP 70 OF PROJECT 81  
SEE MAP 71 OF PROJECT 81  
SEE MAP 72 OF PROJECT 81  
SEE MAP 73 OF PROJECT 81  
SEE MAP 74 OF PROJECT 81  
SEE MAP 75 OF PROJECT 81  
SEE MAP 76 OF PROJECT 81  
SEE MAP 77 OF PROJECT 81  
SEE MAP 78 OF PROJECT 81  
SEE MAP 79 OF PROJECT 81  
SEE MAP 80 OF PROJECT 81  
SEE MAP 81 OF PROJECT 81  
SEE MAP 82 OF PROJECT 81  
SEE MAP 83 OF PROJECT 81  
SEE MAP 84 OF PROJECT 81  
SEE MAP 85 OF PROJECT 81  
SEE MAP 86 OF PROJECT 81  
SEE MAP 87 OF PROJECT 81  
SEE MAP 88 OF PROJECT 81  
SEE MAP 89 OF PROJECT 81  
SEE MAP 90 OF PROJECT 81  
SEE MAP 91 OF PROJECT 81  
SEE MAP 92 OF PROJECT 81  
SEE MAP 93 OF PROJECT 81  
SEE MAP 94 OF PROJECT 81  
SEE MAP 95 OF PROJECT 81  
SEE MAP 96 OF PROJECT 81  
SEE MAP 97 OF PROJECT 81  
SEE MAP 98 OF PROJECT 81  
SEE MAP 99 OF PROJECT 81  
SEE MAP 100 OF PROJECT 81